



ADVANTA Cup 2013

TECHNICAL INFORMATION

Date: 9th-11th August 2013

Organiser: Klub orientačního běhu Dobruška

Competition centre (CC): internát Hradčany, Nové Město nad Metují

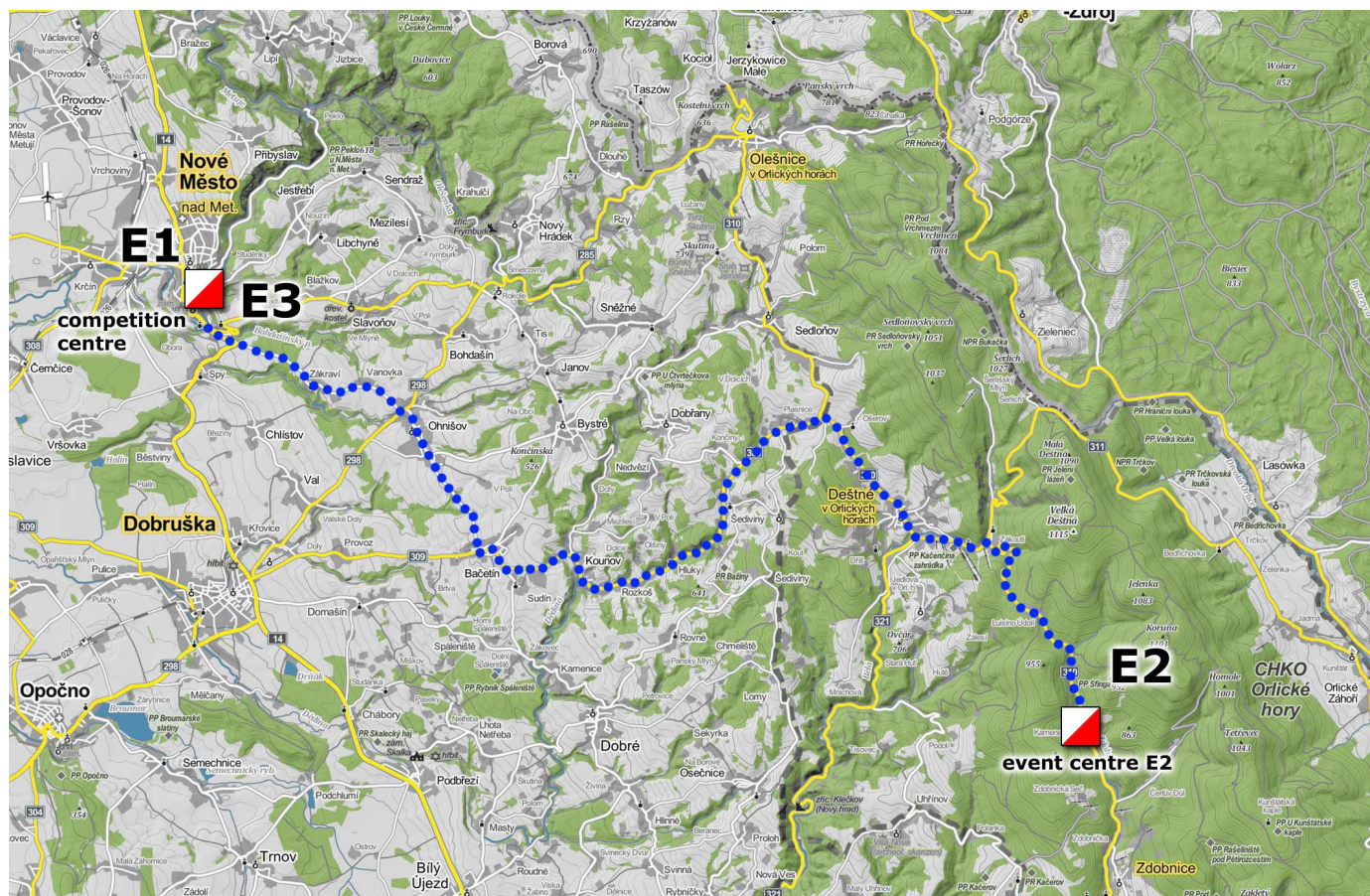

Parking: There is no room for cars in CC, competitors have to park in town (min. 600m from CC). Parking is not organised, we recommended parking behind a city hall (on „náměstí Republiky“ – square of Republic) or next to chateau garden. Of course you can park everywhere according to traffic regulations.

Accommodation:

In CC there is a flat grass area with sufficient place for tents. In CC you can use ToiToi, drink water, cold/hot showers, electricity, maybe wifi. All accommodated competitors will receive a wrist tape and they have to use it. Who won't have a tape and want to sleep in camp, he can buy one for price 300,- Kč.

Registration:

friday 9th August 2013 from 12:00 till 22:00 in CC,
saturday 10th August from 8:30 till 10:00 at event centre E2, 15:00-17:00 in CC
sunday 11th August from 8:30 till 10:00 in CC
Entries are possible till count of vacants in start list.

Refreshment: Is prepared a buffé with classic sortiment – beer, sausage, soap, something sweet, coffee, tea and more. In Nove Mesto there is a lot of restaurants too.

Punching system: SportIDENT will be used for all classes. If SI breaks down, use mechanic punch to map.

Control descriptions: for E1 only on start corridor, other stages in event centre by self service. There is no descriptions on maps!

Start lists: Will be on board in CC. For classes HDR (parents with children), P a T, (start by punching SI unit „Start“) is possible to start anytime till the start is open (start time 0-cca 150).

Maps: All in ISOM, sprints in ISSOM. Special symbols: **O** – distinct tree, **X** – root stock, **X** – small flat object, **X** – other man-made feature
Maps are waterproofed.

Finish: In finish competitor finish his race by punching the Finish SI unit and read-out his chip including those who give up the race. Competitors can keep theirs map. Please be fair and don't show your map to others before theirs start.

Out-of-bounds areas: New clearings, fences, fields, private estates (olive green on map).

Shoes: No restrictions. For E1 we recommend an athletic shoes.

Kindergarten: Will be provided during competition, maybe with some small kid's race.

Protosts: by written form and fee 200,-Kč to main referee

Doctor: basic care for free in finish, serious injuries or events in hospital in Náchod or Rychnov nad Kněžnou

Results: Stage results in event centre, final results in CC. After E3 will be announced the final results and the best three in all classes (not in HDR, P T) will be awarded. Pricegiving ceremony is expected around 14:00.

Expected winner times: according to rules of ČSOS

Attention: Keep rules of orienteering. All participants start at theirs own responsibility. For youths take response theirs parents.

Organising comitee:

director - Tomáš Leštínský

main referee – E1 Tomáš Leštínský (tomas.lestinsky@atlas.cz), E3, NOB Radim Hošek (radimho@gmail.com), E2 Víťa Khýn (vita.khyn@post.cz)

course setters - E1, E2, NOB Tomáš Leštínský, E3 Martin Lžíčář



E1

...read descriptions...

Date: 9th August 2013

Course: sprint

Event centre (EC): internát Hradčany, Nové Město nad Metují

Start: 00 = 17:30, way to starts is marked by white-blue stripes

Distances:

EC - start: 1.1km, 60m

Ec - finish: 0 m

Descriptions: only at start !

Toilets: ToiToi in EC, no toilets at start

Refreshment: in finish sweet drink water

Map: Zázvorka, 1:5000, E 2.5 m, ISSOM

Terrain: Urban area, park, historical downtown

Time limit: 30 minutes

Attention: During competition there are no traffic restrictions! Take **maximal care about yourself**, especially when crossing some street.



Night OB

...sprint how it can be...

Date: 9th August 2013

Course: night sprint

Event centre (EC): internát Hradčany, Nové Město nad Metují

Start: 00 = 22:00

Distances:

Centrum = start = finish

Registration: till 21:30 in EC

Map: Výrov, 1:5000, E 2.5 m, ISSOM

Descriptions: in EC by selfservice

Terrain: Hilly, edge of the city, some rocks, ruined castle Vyrov, some urban areas

Time limit: 40 minutes

Results: on board next day

Pricegiving: only winners before Advanta pricegiving ceremony (sunday 14:00)



E2

...don't give up, others feel the same...

Date: 10th August 2013

Course: long

Event centre: camping Kamenec, Zdobnice

Start: 00 = 10:00, cesta na start bude značena modrobílými fáborky

Distances:

CC - EC: 30 km

EC - parking: 0-2000m

EC - start: 1.8km, 175m (about 40 minutes walk)

EC - start HDR: 0m

EC - finish: 0 m

Parking: Please arrive to EC **only** from Deštné v Orlických Horách. Parking will be provided on one side of narrow local road. Keep traffic rules and park the way that others can pass around your car.

Toilets: ToiToi in EC, WC in building, no toilets on start

Refreshment: Drink warer on start, for classes D21A, H18, H21A, H21B, H35A, H45A on control 90 (cca 3.5km before finish) there will be a water too, in finish sweet water for everyone.

Map: Sfinga (or Orel for long classes), 1:10000, E 5 m, ISOM

Terrain: Hilly mountain clean forest, middle dense of paths, on upper parts not so hilly, open land with labyrinth bulded by dwarf pines.

Time limit: 150 minutes

Attention: In the forrest in lower parts (just before finish) forresters cuting trees. There can be some new paths and clearings!



E3

...one last hill...

Date: 11th August 2013

Course: middle

Event centre: internát Hradčany, Nové Město nad Metují

Start: 00 = 10:00, way to starts is marked by white-blue stripes

Distances:

EC - start: 1.7km, 110m

EC - cíl: 100 m

Toilets: ToiToi in EC, no toilets at start

Refreshment: in finish sweet drink water

Map: Soutěska, 1:10000, E 5 m, ISOM

Terrain: Deep vales with rock and stones changing to plateau with very clean forrest, many paths

Time limit: 100 minutes



Beer relay

...winner is everybody...

Date: 10th August 2013

Event centre: internát Hradčany, Nové Město nad Metují

Entries: at registration desk (Nové Město and Kamenec) at least **till saturday 16:00**

Start fee: 200 Kč per relay

Start: 00 = 17:00

Registration: till 16:00 in EC

Map: Zázvorka, 1:5000, E 2.5 m, ISSOM

Terrain: forrest with one rock, abandoned swimming pool swamp, no paths

Classes: beer boys, spirit girls, outsiders (drink Birell or other alcohol free beer). Deviding to classes is only for pricegiving reasons.

Descriptions: on map only

System:

Warm-ups, 4 relays to finale.

Warm-up: On start first member drinks whole beer bottle (girls a big snorter) abd run his course (0.6-1 km free order 4c + last compulsory control 120, total 5 controls), than pass his SI to second member, he do the same as the first one, last ember punch finish. Every leg has it§s own map. Be carefull for codes! Count of warm-ups is up to a count of relays

Final race: Regular relays, big beer in start and in the finish. Every competitor need his own chip!

Pricegiving: after race is over in EC.

Director: Radim Hošek

All organisers wish you a good speed !



Courses lengths

ADVANTA Cup 2013

class	E1	E2	E3
D10	1.6km, 25m, 10k	1.9km, 25m, 6k	2.7km, 85m, 7k
D12	1.6km, 25m, 13k	2.1km, 35m, 6k	2.9km, 85m, 9k
D14	1.8km, 25m, 13k	3.0km, 70m, 11k	3.1km, 120m, 12k
D16	2.0km, 35m, 15k	3.9km, 170m, 14k	3.5km, 110m, 14k
D18	2.0km, 35m, 16k	5.0km, 175m, 13k	3.6km, 140m, 14k
D21A	2.2km, 35m, 18k	6.7km, 200m, 20k	3.8km, 190m, 18k
D21B	2.0km, 35m, 16k	4.4km, 140m, 14k	3.3km, 160m, 16k
D35A	2.0km, 25m, 19k	5.2km, 190m, 16k	3.5km, 150m, 15k
D35B	1.8km, 35m, 15k	3.5km, 125m, 10k	3.5km, 110m, 14k
D45A	1.7km, 25m, 16k	4.4km, 170m, 12k	3.6km, 140m, 14k
D45B	1.6km, 25m, 15k	3.4km, 75m, 13k	3.1km, 125m, 14k
D55	1.6km, 25m, 14k	3.4km, 75m, 13k	3.1km, 125m, 14k
D65	1.6km, 25m, 14k	3.1km, 75m, 9k	2.5km, 90m, 11k
H10	1.6km, 25m, 10k	1.9km, 25m, 6k	2.7km, 85m, 7k
H12	1.6km, 25m, 13k	2.2km, 35m, 8k	3.0km, 85m, 11k
H14	1.8km, 25m, 14k	3.1km, 130m, 10k	3.6km, 125m, 14k
H16	1.9km, 35m, 15k	5.2km, 200m, 13k	3.5km, 140m, 15k
H18	2.1km, 35m, 17k	7.0km, 255m, 21k	4.5km, 190m, 17k
H21A	2.4km, 35m, 20k	9.1km, 350m, 27k	5.1km, 225m, 23k
H21B	2.3km, 35m, 17k	6.0km, 200m, 18k	4.7km, 210m, 24k
H35A	2.0km, 35m, 20k	8.5km, 290m, 21k	4.5km, 190m, 17k
H35B	1.9km, 25m, 16k	5.4km, 200m, 16k	4.1km, 180m, 14k
H45A	1.9km, 25m, 19k	6.2km, 230m, 17k	3.9km, 175m, 17k
H45B	1.8km, 25m, 14k	4.3km, 135m, 12k	3.8km, 125m, 16k
H55A	1.7km, 25m, 17k	4.6km, 155m, 12k	3.2km, 145m, 17k
H55B	1.7km, 25m, 17k	3.3km, 135m, 9k	2.9km, 125m, 14k
H65	1.5km, 25m, 15k	3.2km, 85m, 12k	2.5km, 90m, 11k
H75	1.5km, 25m, 15k	3.1km, 75m, 9k	2.5km, 90m, 11k
P	1.6km, 25m, 11k	2.3km, 35m, 10k	3.0km, 85m, 11k
T	1.7km, 25m, 19k	5.0km, 200m, 20k	3.8km, 140m, 17k
HDR	1.1km, 25m, 7k	1.2km, 70m, 5k	2.6km, 90m, 7k

Night OB	
D12N	1,6km, 75m, 7k
D16N	1,9km, 85m, 9k
D21N	2,3km, 100m, 14k
D45N	2,1km, 85m, 11k
H12N	1,6km, 75m, 7k
H16N	2,1km, 95m, 12k
H21N	2,9km, 140m, 17k
H45N	2,3km, 115m, 13k
H55N	1,7km, 75m, 8k
MIX	1,9km, 85m, 9k



Competition centre situation map

Nové Město nad Metují

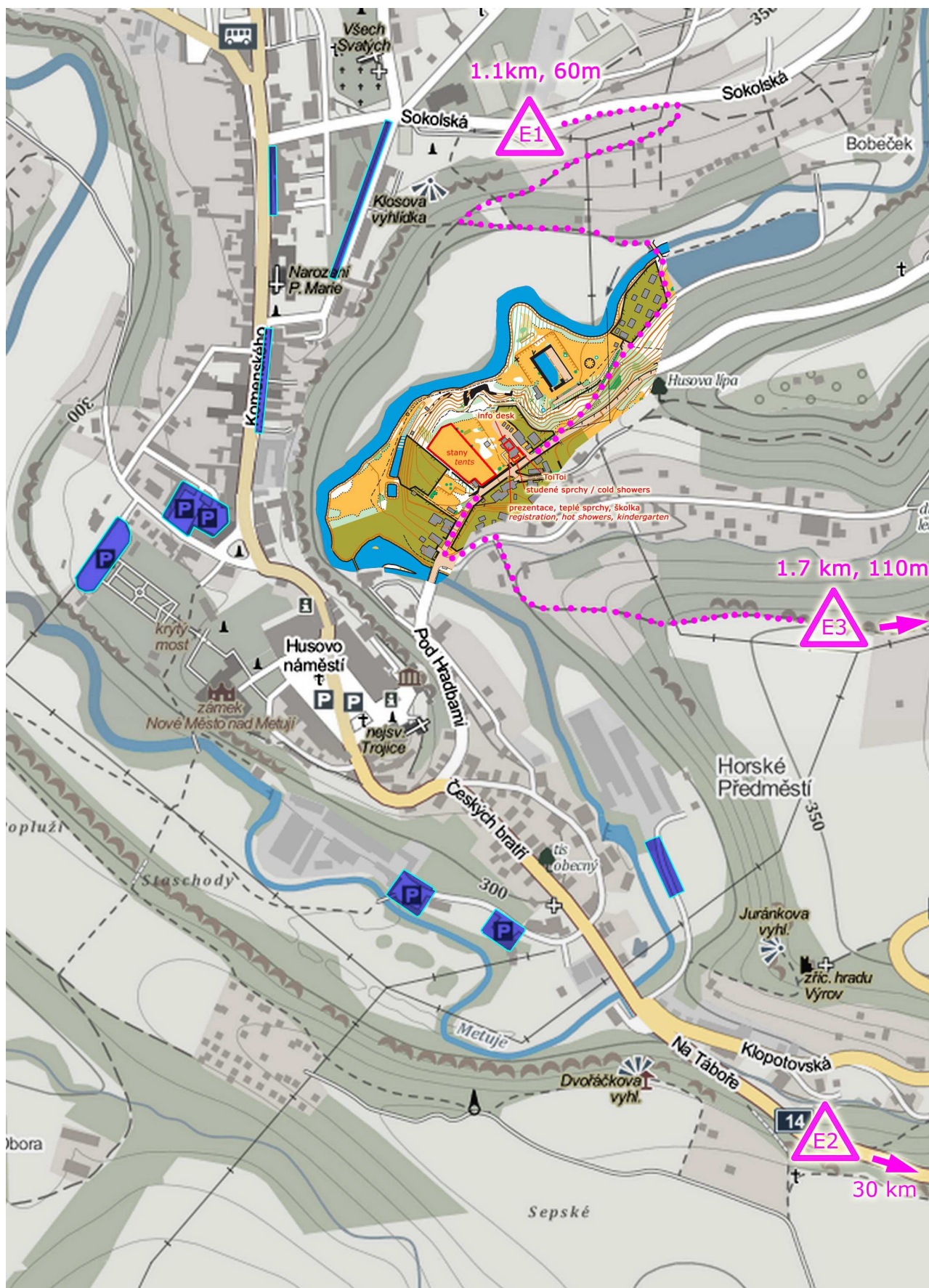



Competition centre situation map - zoom

Nové Město nad Metují

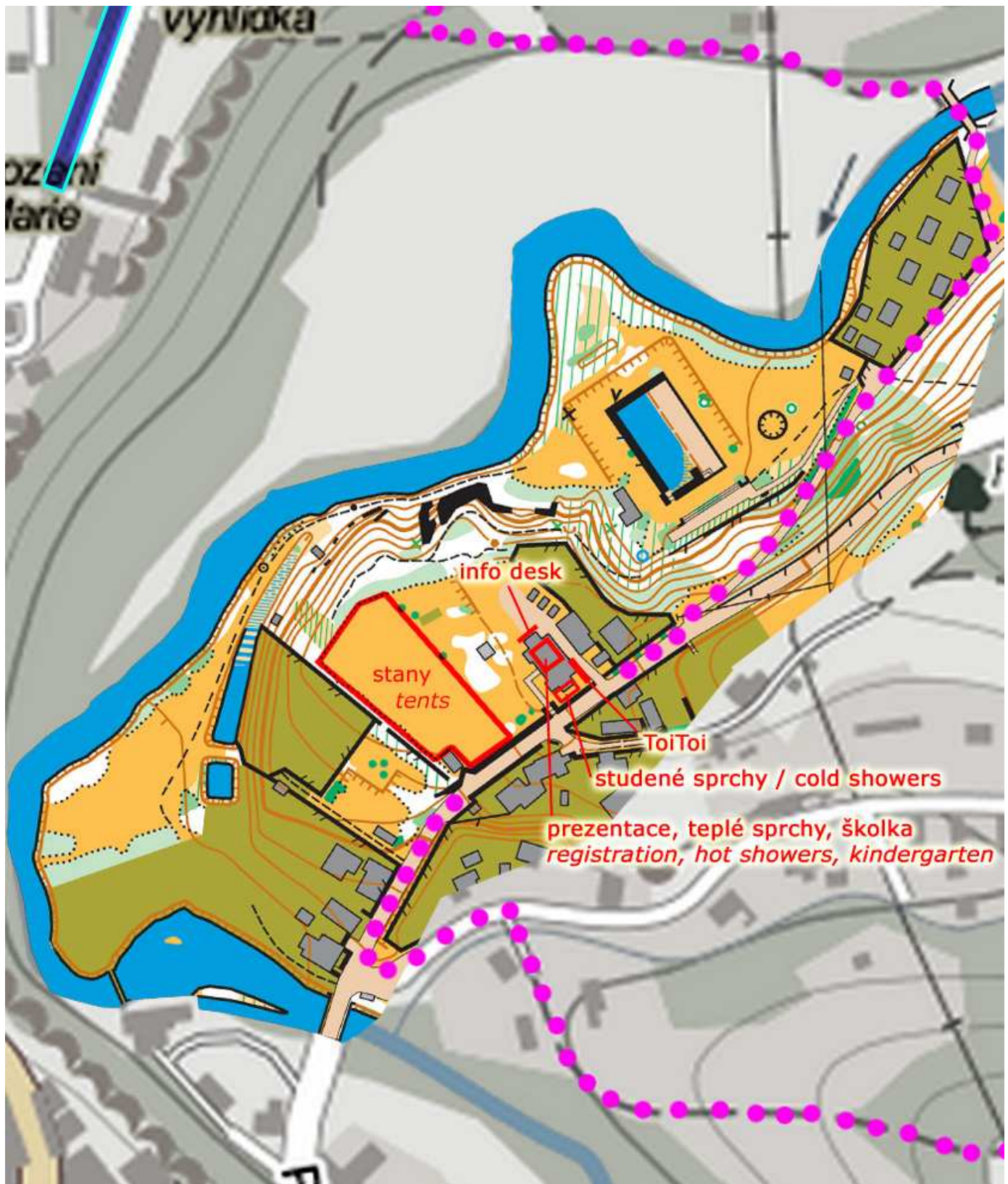



Event centre E2

Kamenec

